



CENTRAL TEXAS
Regional Mobility Authority

Welcome and opening remarks by the Chairman and the Board of Directors

Agenda Item #1

February 24, 2016



CENTRAL TEXAS
Regional Mobility Authority

Opportunity for Public Comment

Agenda Item #2

February 24, 2016



CENTRAL TEXAS
Regional Mobility Authority

Consent Agenda

Agenda Items #3-10

February 24, 2016



CENTRAL TEXAS
Regional Mobility Authority

Regular Items

Agenda Items #11-14

February 24, 2016



CENTRAL TEXAS
Regional Mobility Authority

Approve the minutes for the January 27, 2016, Regular Board Meeting

Agenda Item #11

Geoff Petrov

February 24, 2016



CENTRAL TEXAS
Regional Mobility Authority

Approve the minutes for the February 16, 2016, Special Called Board Meeting

Agenda Item #12

Geoff Petrov

February 24, 2016



CENTRAL TEXAS
Regional Mobility Authority

Accept the financial statements for January 2016

Agenda Item #13

Mary Temple

February 24, 2016



CENTRAL TEXAS
Regional Mobility Authority

Authorize the Issuance, Sale and Delivery of Central Texas Regional Mobility Authority Senior Lien Revenue Refunding Bonds, Series 2016, in Accordance with Specified Parameters

Agenda Item #14

Bill Chapman, Chief Financial Officer

February 24, 2016



CENTRAL TEXAS
Regional Mobility Authority

Briefings and Reports

Agenda Items #15-19

February 24, 2016



CENTRAL TEXAS
Regional Mobility Authority

MoPac Improvement Project

Agenda Item #15

Steve Pustelnyk, Director of Community Relations

February 24, 2016



CENTRAL TEXAS
Regional Mobility Authority

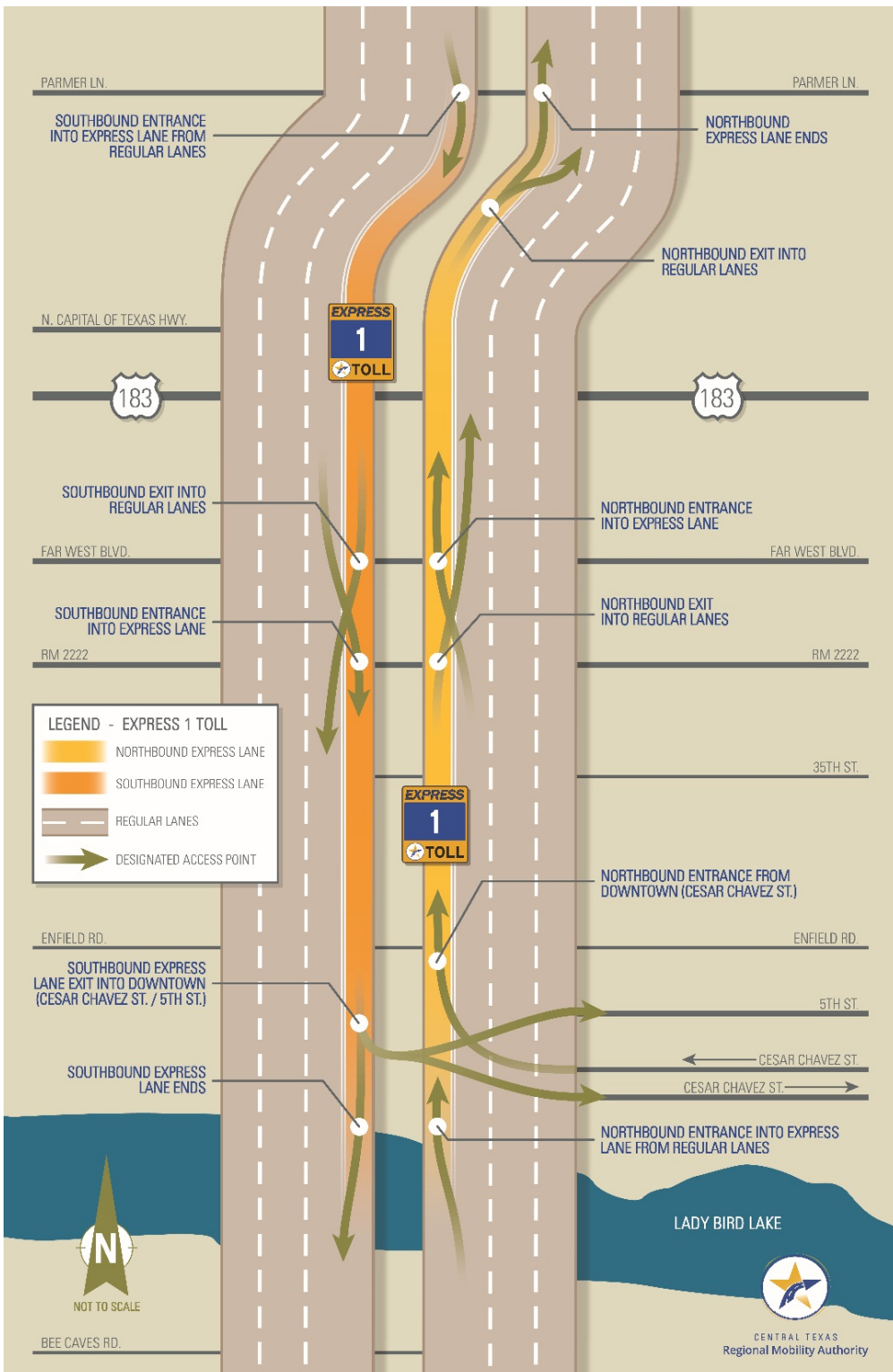

MOPAC IMPROVEMENT PROJECT

Construction Progress

◀◀ MOPAC
IMPROVEMENT
PROJECT ▶▶



Underpass NB Express Lane

Photos to
be added
after lane
shift occurs
on
February
20th

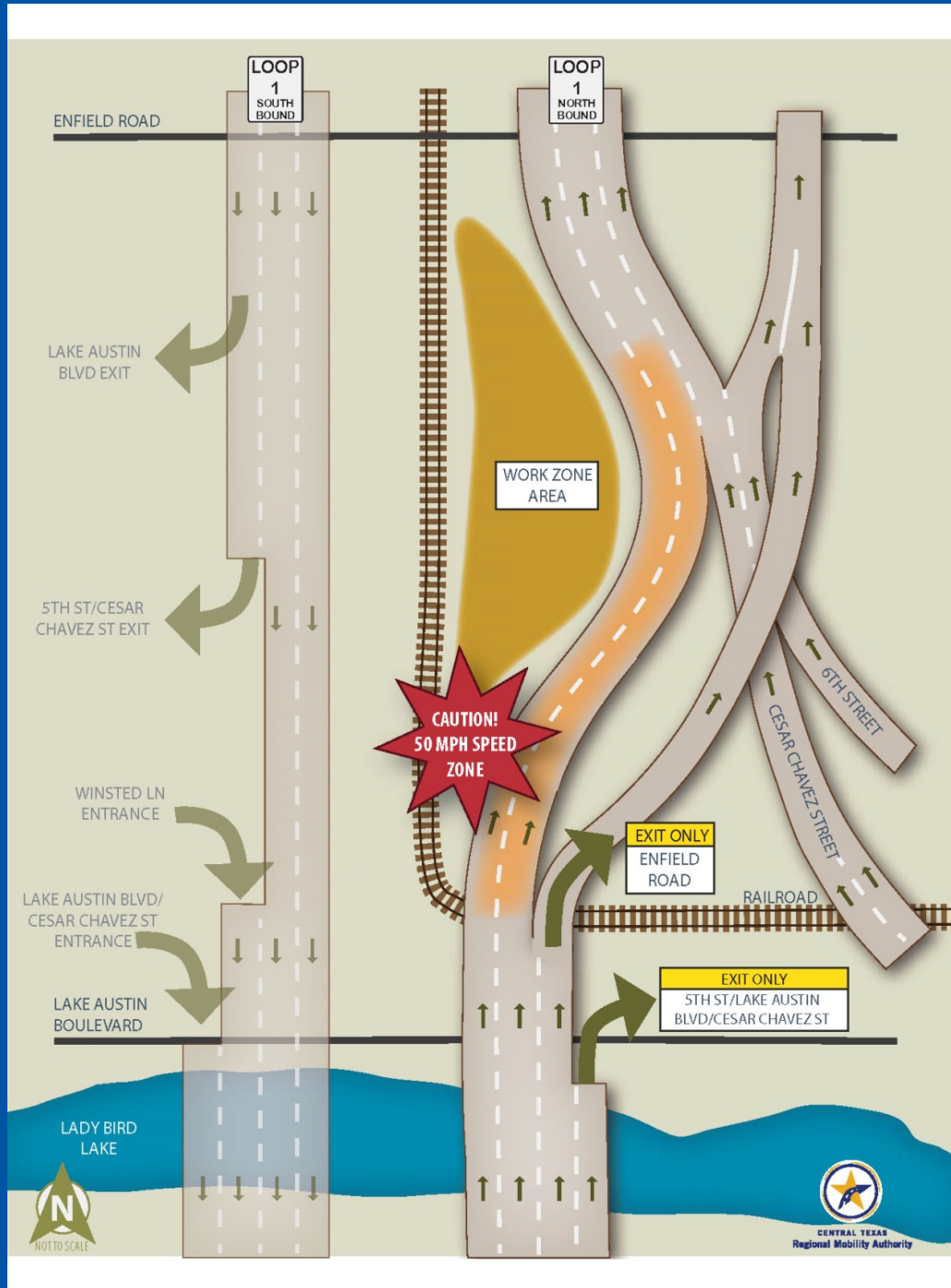

Underpass SB Express Lane



Underpass SB Express Lane



Sound Wall 16



Sound Wall 15



Sound Wall 15



NB Windsor Bridge



NB Westover Bridge



NB RM 2222 Bridge



183 3/4
Capital of Tx Hwy
Braker Ln 1
1325 SOUTH 3

Sidewalk
NB Frontage
Road

SPEED
LIMIT
50



Express Lanes At Far West



35th Street Ramp Widening



Community Outreach

◀ MOPAC
IMPROVEMENT
PROJECT ▶▶



Primary Interest Issue



New on ramp at Cesar Chavez

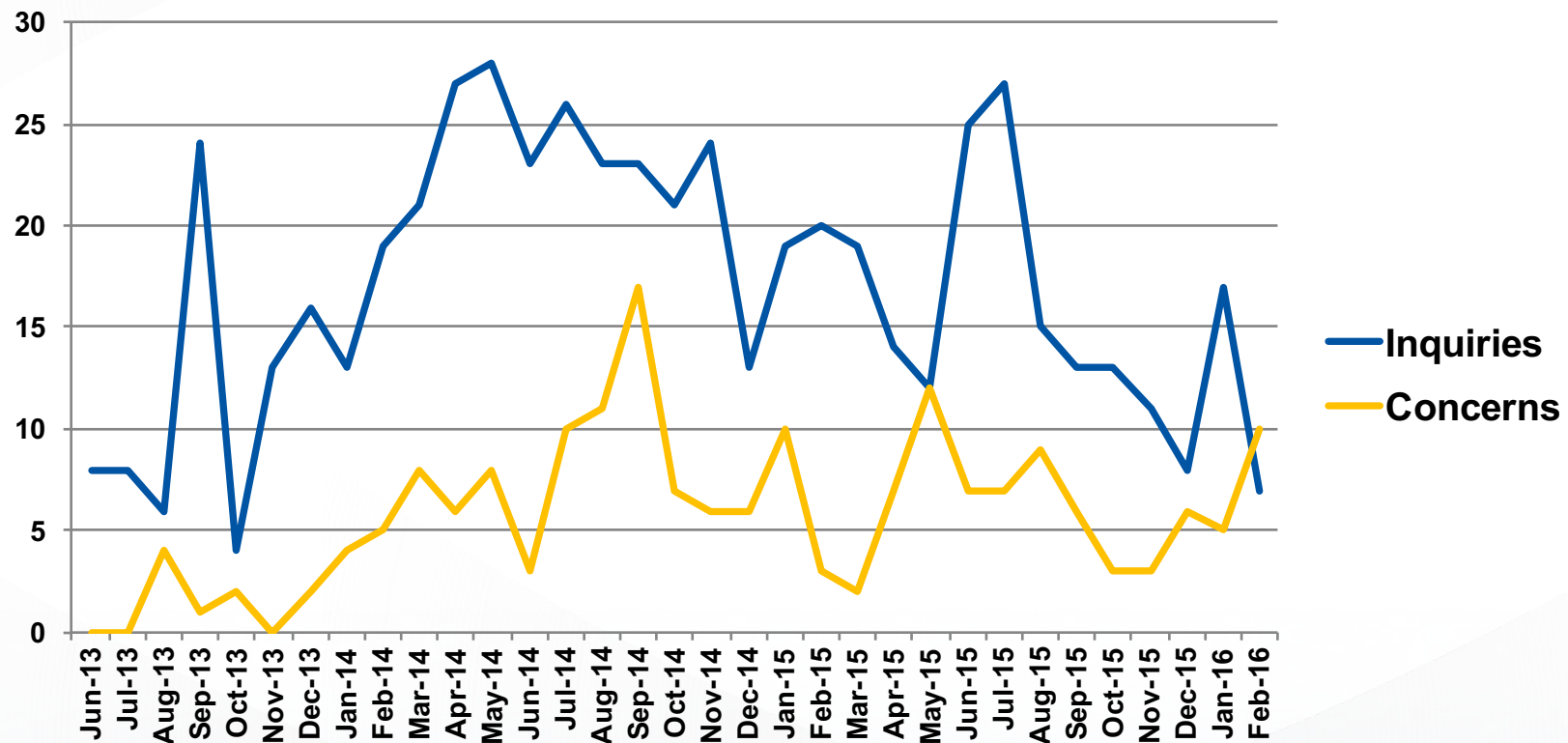

Upcoming Work and Outreach



- **Increased Nighttime and Weekend Activity**
- **Repaving of Bridge Approaches at Union Pacific Rail Crossing and Capital Metro Rail Crossing**
- **Construction of Sound Wall 8 along northbound MoPac between 35th Street and 45th Street**

Progress Metrics

◀◀ MOPAC
IMPROVEMENT
PROJECT ▶▶



Progress Metrics



MOPAC IMPROVEMENT PROJECT - PROJECT PROGRESS METRICS

(January-2016)

100,000	105,000	110,000	115,000	120,000	125,000	130,000	135,000	140,000	145,000	150,000	155,000	160,000	165,000	170,000	175,000	180,000	185,000	190,000	195,000	200,000	205,000	210,000	215,000	220,000	225,000	230,000	235,000	240,000	245,000	250,000	255,000	260,000	265,000	270,000	275,000	280,000	285,000	290,000	295,000	300,000	305,000	310,000	315,000	320,000	325,000	330,000	335,000	340,000	345,000	350,000	355,000	360,000	365,000	370,000	375,000	380,000	385,000	390,000	395,000	400,000	405,000	410,000	415,000	420,000	425,000	430,000	435,000	440,000	445,000	450,000	455,000	460,000	465,000	470,000	475,000	480,000	485,000	490,000	495,000	500,000	505,000	510,000	515,000	520,000	525,000	530,000	535,000	540,000	545,000	550,000	555,000	560,000	565,000	570,000	575,000	580,000	585,000	590,000	595,000	600,000
SEGMENT 1										SEGMENT 2A										SEGMENT 2B										SEGMENT 3										SEGMENT 4																																																												

Schedule (EV)



Planned :
Earned :
SPI:

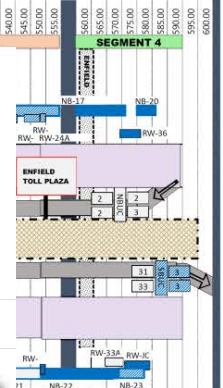
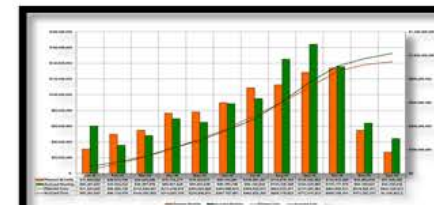
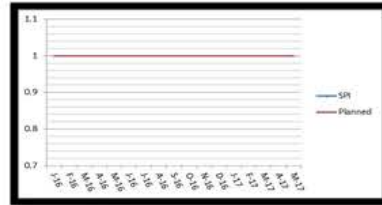
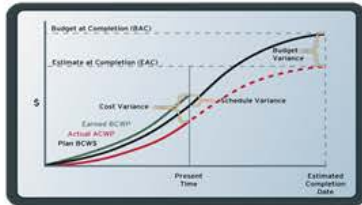

Labor



Planned :
Earned :
LPI:

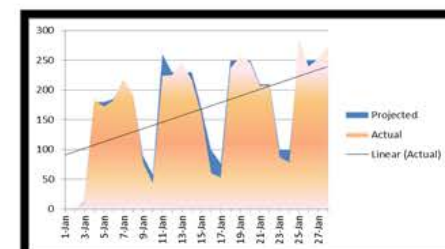
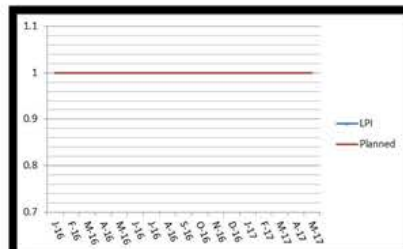
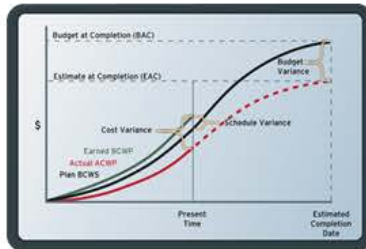

Budget



Planned :
Earned :
CPI:

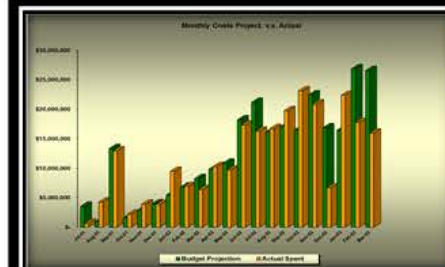
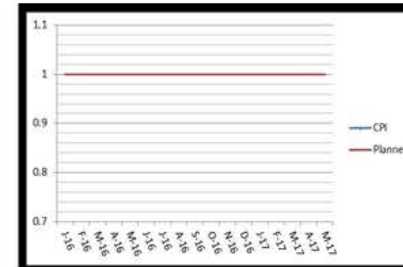

Progress Metrics



MOPAC IMPROVEMENT PROJECT - PROJECT PROGRESS METRICS

(January-2016)

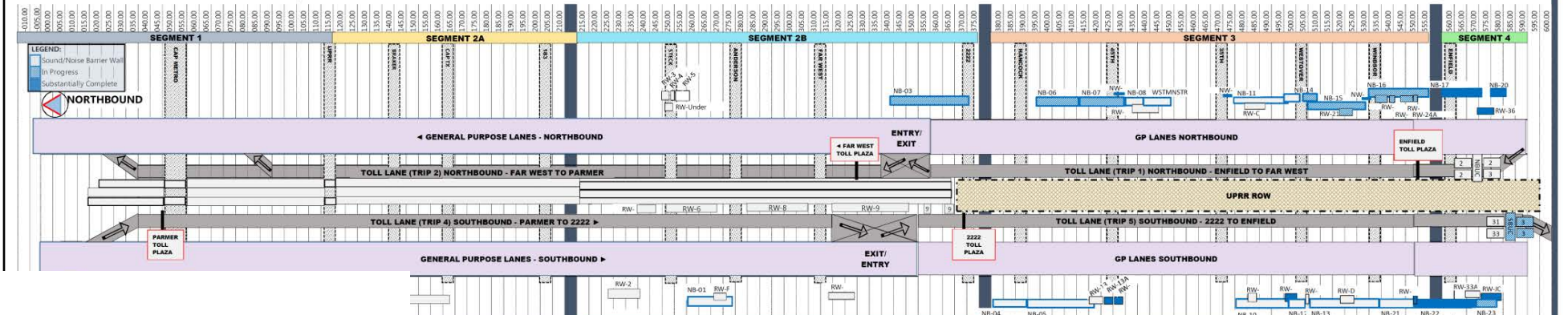

Performance

Executed CO/EWO + Supplement (%)

Potential CO/EWO + Supplement (%)

Schedule (%)

Earned (%)

Paid (%)

Complete: 556 (78%)

Future: 27 (4%)

Active: 132 (18%)

Segment 2B

Schedule (EV)

Planned:

Earned:

SPE:

Labor

Planned:

Earned:

SPE:

Budget

Planned:

Earned:

SPE:

Dependencies

Opportunity / Risk

Assumptions

Issues

Dependencies

Segment 3

Schedule (EV)

Planned:

Earned:

SPE:

Labor

Planned:

Earned:

SPE:

Budget

Planned:

Earned:

SPE:

Dependencies

Opportunity / Risk

Assumptions

Issues

Dependencies

Public Outreach for Projects

Agenda Item #16

Dee Anne Heath, Director of External Affairs

February 24, 2016



CENTRAL TEXAS
Regional Mobility Authority

Outreach Updates



183 North

RECENT ACTIVITY

- Responded to stakeholder questions and comments about project, sound walls
- Comments posted on website December 2015

NEXT STEPS

- Continue to work with media to share project news with the public
- Comment Response document under final review – estimated completion February 2016
- Environmental Finding – estimated Spring 2016

KEY ENGAGEMENT STATISTIC

- There was a 27% increase in website traffic in January 2016 from December 2015 (*68% of these visitors were new to the site*)



183 South

RECENT ACTIVITY

- **Worked to improve branding / graphics and toward finalization of overall outreach plan**

NEXT STEPS

- **Plan for a series of community presentations as part of overall outreach efforts**

KEY ENGAGEMENT STATISTIC

- **12 new sign-ups for construction alerts, 4 inquiries via website, and 3 new Twitter followers in January (*expect more once construction starts in earnest.*)**



SH 71 Express

RECENT ACTIVITY

- Sent 12 email alerts in January to the email database about upcoming construction activity and lane closures

NEXT STEPS

- Plan for Public Informational Construction Update Meeting March 2016
- Open to traffic Summer 2016

KEY ENGAGEMENT STATISTIC

- There was a 58% increase in new visitors to the project website. The construction activity information page was viewed the longest (*avg of 2 minutes per page visit*)

Outreach Updates



SH 45SW

RECENT ACTIVITY

- Finalizing documentation for reevaluation (*includes outreach documentation*)
- *Comments posted on website January 2016*

NEXT STEPS

- Continue work with contractors to raise awareness and interest in current and future RFQs
- Comment Response document – under final review. Estimated completion is February 2016.
- Second phase of funding approval – Spring 2016
- Construction procurement – Spring 2016

KEY ENGAGEMENT STATISTIC

- The project website had 924 visitors (181 new visitors) in January. These figures are on par with December visitation, and significantly higher than November visitation.

Outreach Updates



183 North

RECENT ACTIVITY

- **CAMPO Policy Board approved 2040 Plan Amendment**

NEXT STEPS

- **Submit revised Draft Environmental Assessment and Public Hearing Summary Report (report will be available at 183North.com when final)**
- **Environmental Finding – Spring 2016**

KEY ENGAGEMENT STATISTIC

- **February 8th – 10th : 25 Tweets @183North resulted from the CAMPO Board meeting**

Outreach Updates



MoPac South

RECENT ACTIVITY

- 4th Technical Work Group meeting was held on February 5
- Comments posted on website January 2016

NEXT STEPS

- Analyze feedback, adjust evaluation criteria as needed
- Comment Response document under final review – estimated completion February 2016
- Public Hearing – expected Summer of 2016
- Environmental Finding – Early 2017

KEY ENGAGEMENT STATISTIC

- Seven visitors downloaded raw comments from Open House #4



OakHill Parkway

RECENT ACTIVITY

- Held a stakeholder meeting on February 2nd hosted by City of Dripping Springs with 30 in attendance

NEXT STEPS

- Launch promoted social media campaign around three newly released project informational videos
- Comments – TxDOT is leading the Environmental Study, posting is at their discretion and currently being evaluated by the project team.
- Comment Response document – under development by TxDOT. Estimated completion is March 2016.
- Stakeholder Outreach/Public Workshops - 2016
- Public Hearing – January 2017 (tentative)

KEY ENGAGEMENT STATISTIC

- @OakHillParkway Twitter account doubled profile visits in January, more than doubled twitter impressions, and gained 16 new followers

General Engineering Consultant (GEC) Procurement

Agenda Item #17

Justin Word, P.E., Director of Engineering

February 24, 2016



CENTRAL TEXAS
Regional Mobility Authority

GEC Procurement Schedule



October 28, 2015
Board Approved
Procurement

March 2016
Board Approves
Selection

February 1, 2016
RFQs Received



2016

January 7, 2016
Issued Final RFQ

April 2016
Board Approves
Contract & Work
Authorization

November 16, 2015
Issued Draft RFQ

March 2016
Interviews

Proposers
HDR
HNTB
Parsons Brinckerhoff

LEGEND



45SW Construction Engineering & Inspection Procurement

Agenda Items #18

Justin Word, P.E., Director of Engineering

February 24, 2016



CENTRAL TEXAS
Regional Mobility Authority



- **Construction Engineering**
 - Project Management
 - Cost and Schedule Tracking
 - Change Order Processing
- **Construction Inspection**
 - Quality Control and Assurance
 - Materials Testing & Inspection
 - Compliance Reporting



SH 45SW CE&I Procurement Schedule



January 29, 2016
Issuance of RFQ

April 14/15, 2016
Potential Interview
Date(s)

March 1, 2016
RFQs Responses

May/June
Anticipated Notice to
Proceed Date

2016

LEGEND

PROCUREMENT

March 8, 2016
Deadline for Proposals

April 27, 2016
Anticipated Selection by
Mobility Authority Board

February 26, 2016
RFQ Question
Submittal Deadline



Executive Directors Report Project Updates

Agenda Item #19-A

Mike Heiligenstein, Executive Director

February 24, 2016



CENTRAL TEXAS
Regional Mobility Authority

Executive Directors Report Public Information Coordinator

Agenda Item #19-B

Mike Heiligenstein, Executive Director

February 24, 2016



CENTRAL TEXAS
Regional Mobility Authority

Executive Session

Agenda Items #20-23

February 24, 2016



CENTRAL TEXAS
Regional Mobility Authority

Adjourn Meeting

Agenda Item #24

February 24, 2016



CENTRAL TEXAS
Regional Mobility Authority



CENTRAL TEXAS
Regional Mobility Authority